

南三陸町 復興特別区域

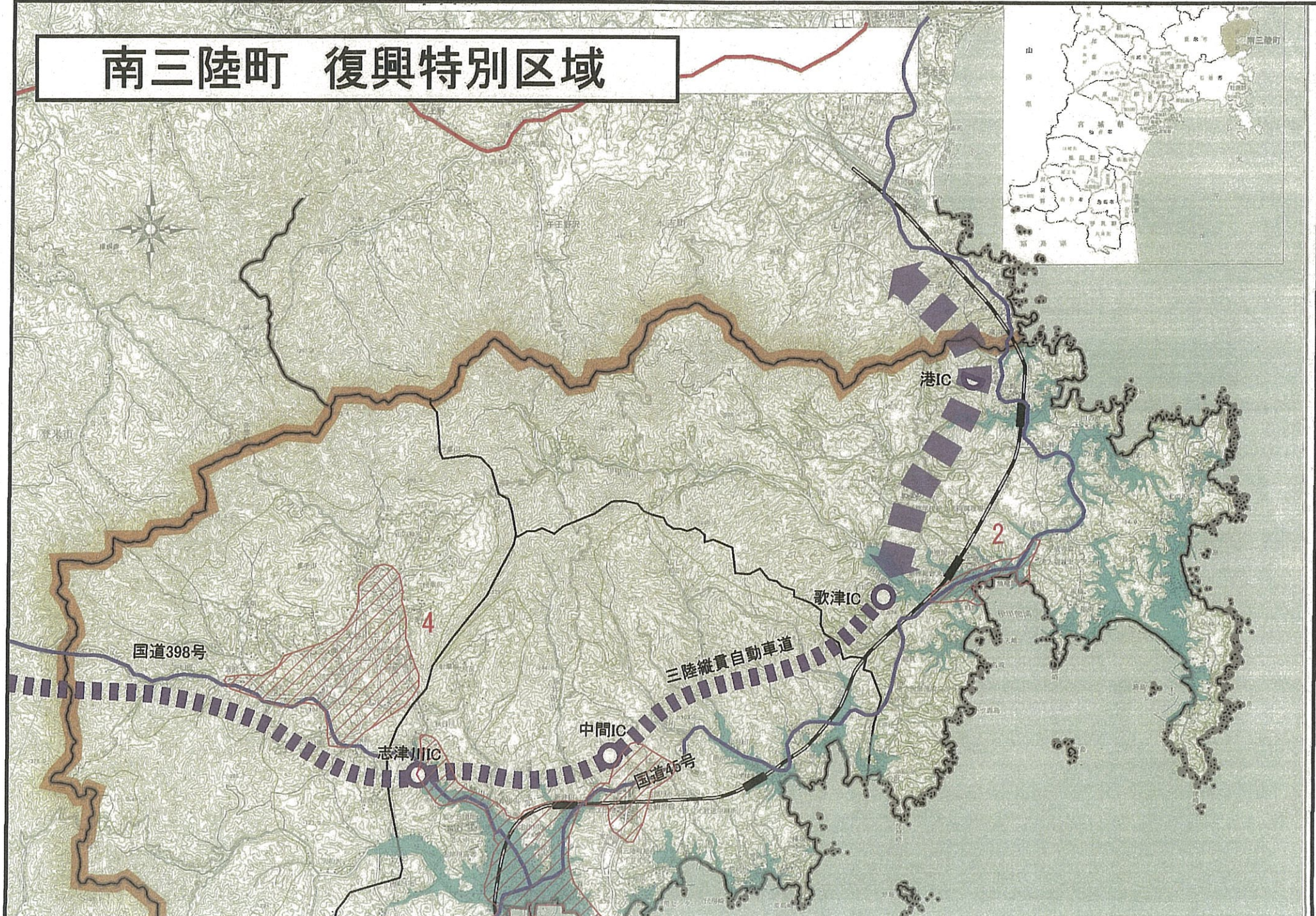

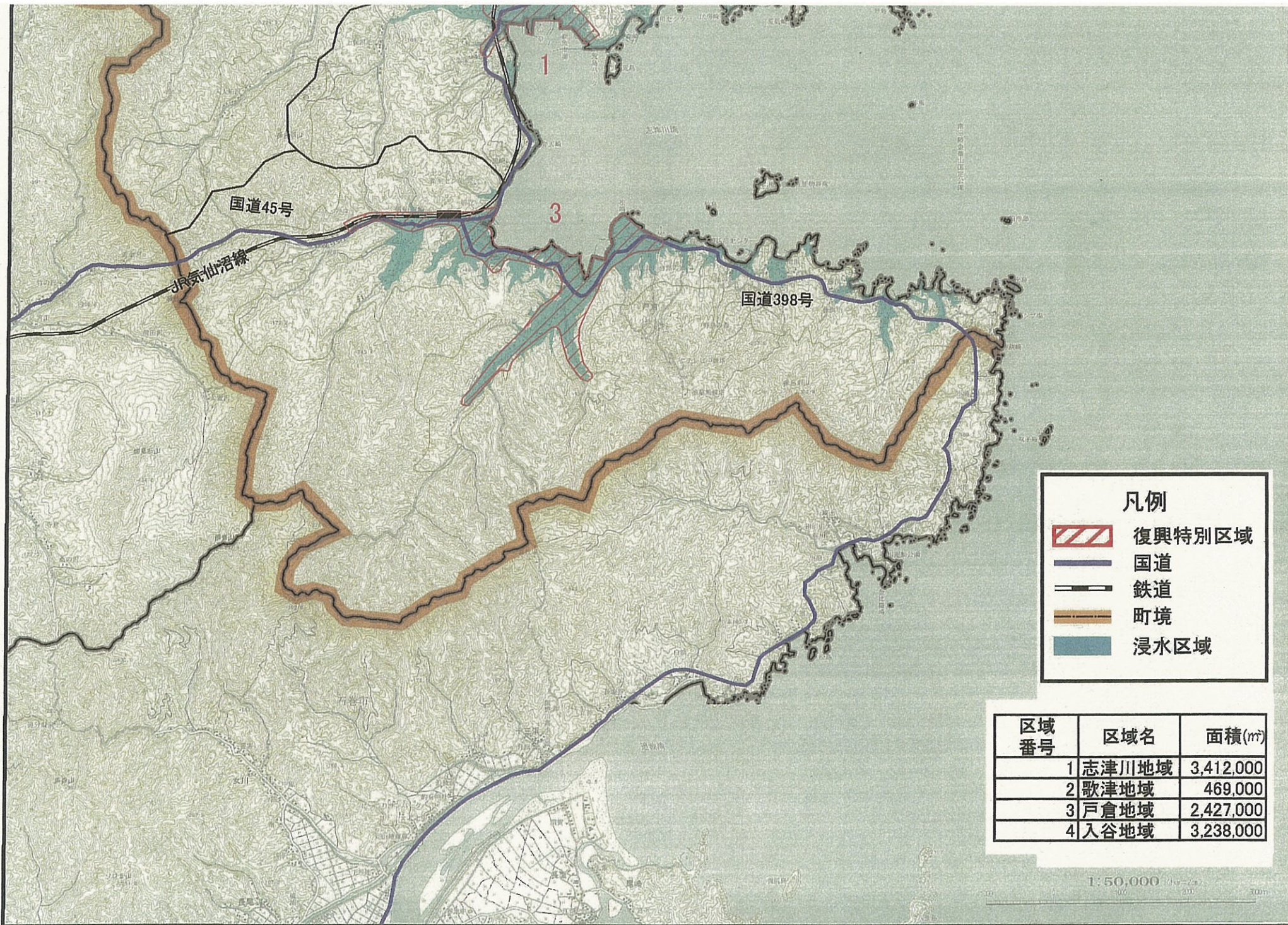

志津川地域(塩入)



116-1
115
112-2
112-3
112-4
112-5
112-6
112-7
112-8
112-9
112-10
112-11
112-12
112-13
112-14
112-15
112-16
112-17
112-18
112-19
112-20
112-21
112-22
112-23
112-24
112-25
112-26
112-27
112-28
112-29
112-30
112-31
112-32
112-33
112-34
112-35
112-36
112-37
112-38
112-39
112-40
112-41
112-42
112-43
112-44
112-45
112-46
112-47
112-48
112-49
112-50
112-51
112-52
112-53
112-54
112-55
112-56
112-57
112-58
112-59
112-60
112-61
112-62
112-63
112-64
112-65
112-66
112-67
112-68
112-69
112-70
112-71
112-72
112-73
112-74
112-75
112-76
112-77
112-78
112-79
112-80
112-81
112-82
112-83
112-84
112-85
112-86
112-87
112-88
112-89
112-90
112-91
112-92
112-93
112-94
112-95
112-96
112-97
112-98
112-99
112-100
112-101
112-102
112-103
112-104
112-105
112-106
112-107

志津川地域(塩入)

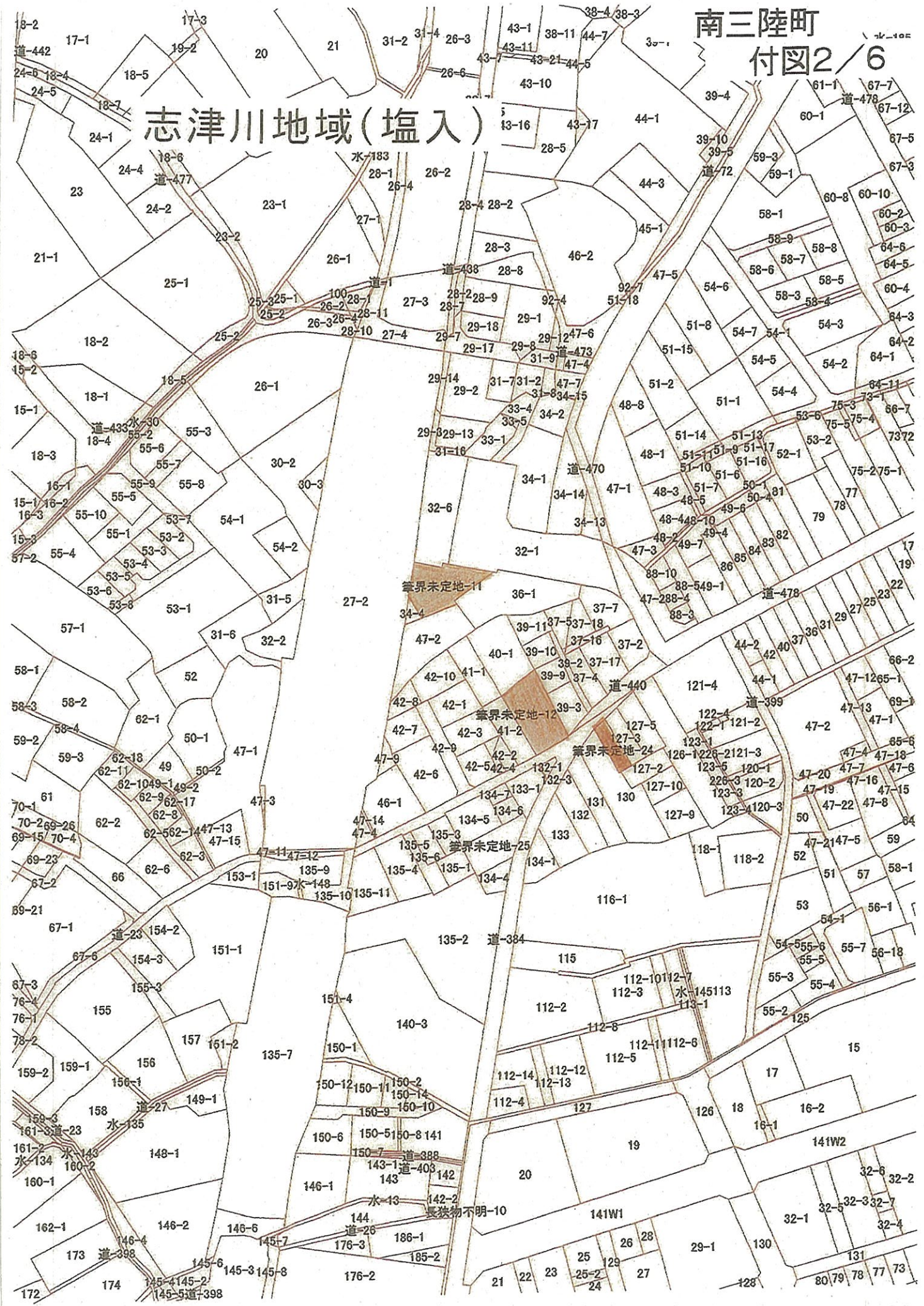

入谷地域(水口沢)



入谷地域(童子下)

